



THOMAS
MERRIFIELD
FOR SALE
01235 813792

1 Viking Drive,
Didcot, Oxfordshire, OX11 9RD

1 Viking Drive, Didcot, Oxfordshire, OX11 9RD

A rarely available and beautifully presented four bedroom detached family home with double garage, manicured rear garden and impressive kitchen diner located in this cul-de-sac location on the Fleet Meadow development.

The accommodation comprises entrance hall with engineered oak floor, cloakroom, large lounge with open fire, and refitted shaker style kitchen-diner. On the first floor there is a refitted family bathroom and four bedrooms; the master with lovely refitted en-suite shower room & fitted wardrobes. To the front and side of the property is a lawn and double driveway which leads to a double garage with light & power. Finally, to the rear; there is a manicured garden with patio and side access. For the property to be fully appreciated; viewings are highly recommended.

The town of Didcot offers comprehensive leisure and sporting facilities for all ages, and has a shopping complex which opened in 2005, named the Orchard Centre, with multiplex cinema, Cornerstone art centre and various cafes and restaurants. Didcot has excellent road links to the A34 which in turn lead to the M40 in the north and the M4 in the south. There is also an excellent mainline train service into London Paddington from Didcot Parkway, (approx. 40 minutes).





- Beautifully presented four bedroom detached family home
- Double driveway & double garage
- Modern shaker style kitchen-diner
- Impressive lounge with open fire running the length of the house
- En-suite to principal bedroom
- Cul-de-sac location
- Local Authority: South Oxfordshire District Council
- Council Tax Band: E
- Tenure: Freehold

Approximate Gross Internal Area
 Ground Floor = 51.1 sq m / 550 sq ft
 First Floor = 51.9 sq m / 559 sq ft
 Garage = 29.4 sq m / 316 sq ft
 Total = 132.4 sq m / 1,425 sq ft



**THOMAS
MERRIFIELD**

SALES LETTINGS

103 Broadway, Didcot, Oxon, OX11 8AL
 didcot@thomasmerrifield.co.uk
 Tel: 01235 813777

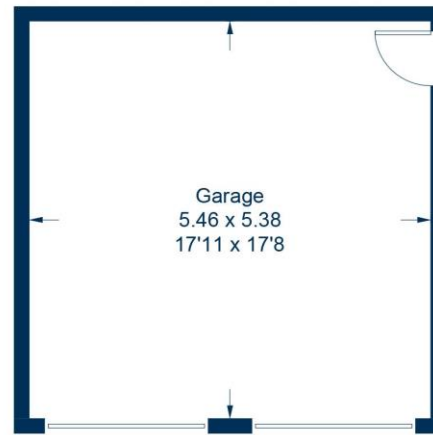

(Not Shown In Actual Location / Orientation)

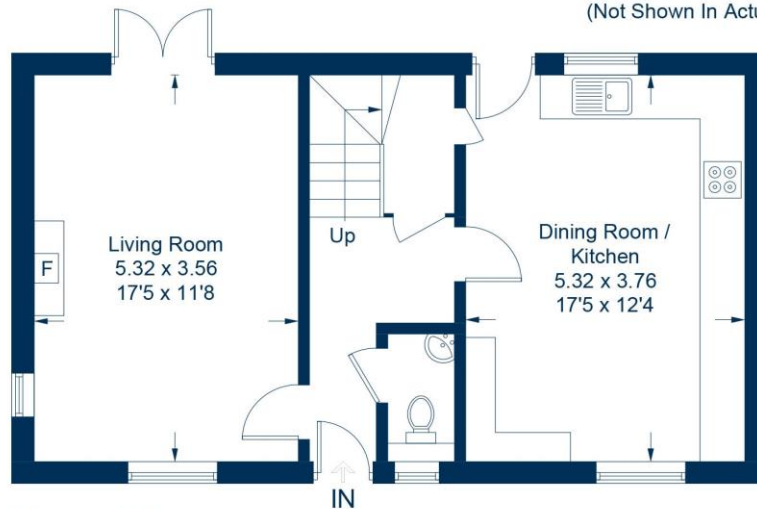

Ground Floor

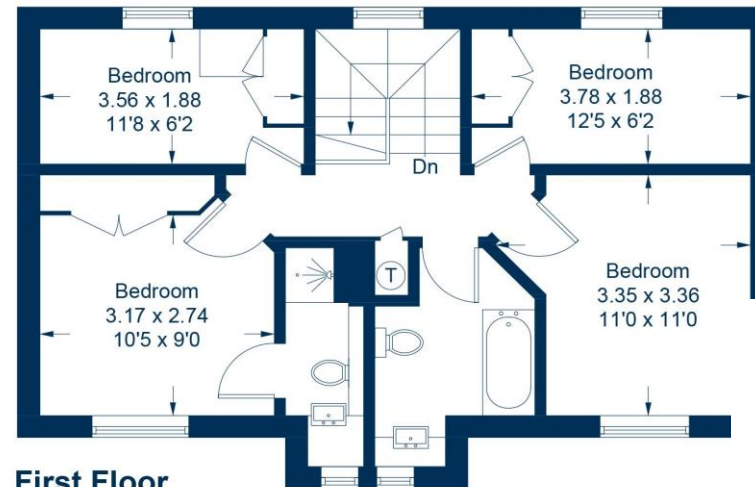

First Floor

This plan is for layout guidance only. Not drawn to scale unless stated. Windows and door openings are approximate. Whilst every care is taken in the preparation of this plan, please check all dimensions, shapes and compass bearings before making any decisions reliant upon them.

© CJ Property Marketing Ltd

Important Notice

Thomas Merrifield and their clients give notice that:

1. They are not authorised to make or give any representations or warranties in relation to the property either here or elsewhere, either on their own behalf or on behalf of their client or otherwise. They assume no responsibility for any statement that may be made in these particulars. These particulars do not form any part of any offer or contract and must not be relied upon as statements or representations of fact.

2. Any areas, measurements or distances are approximate. The text, photographs and plans are for guidance only and are not necessarily comprehensive. It should not be assumed that the property has all necessary planning, building regulation or other consents and Thomas Merrifield have not tested any services, equipment or facilities. Purchasers must satisfy themselves by inspection or otherwise.